

**PHILIPS**

*QuickClear*

Thrombectomy  
system

Powerfully  
simple



Philips QuickClear thrombectomy system is a simple solution that provides an all-in-one, single-use aspiration pump and catheter for peripheral arterial and venous cases. Its powerfully simple design requires no capital equipment, maximizes aspiration power and supports faster set-up and procedure times.

## Powerful Powerfully simple design

QuickClear provides the same aspiration power as competing mechanical thrombectomy systems without the need for capital equipment.

With the largest mechanical thrombectomy catheter size available, the QuickClear 10F mechanical thrombectomy system provides 59% more aspiration volume.\*

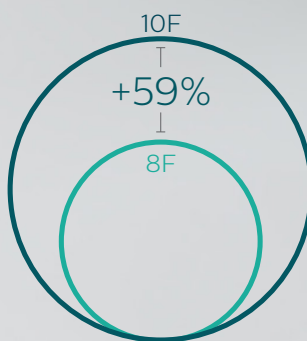

**10F vs 8F**

The QuickClear thrombectomy system provides consistent controlled aspiration pressure while the Boston Scientific AngioJet thrombectomy system demonstrates inconsistent aspiration pressure.\*

The QuickClear thrombectomy system has over three times the aspiration pressure of the AngioJet thrombectomy system.\*

**QuickClear vs AngioJet aspiration pressure**

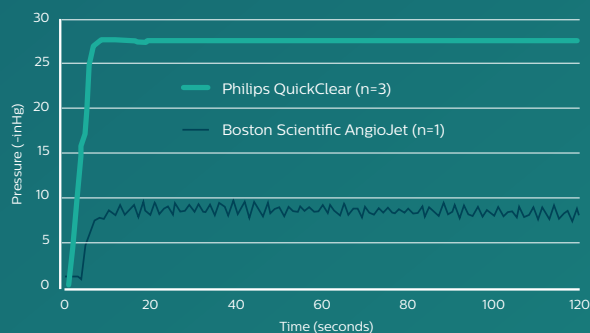

\*Tests performed and data on file D056459

*The QuickClear system has over 2X the suction force of Penumbra Indigo.\**

**QuickClear vs Penumbra suction force (gf)**

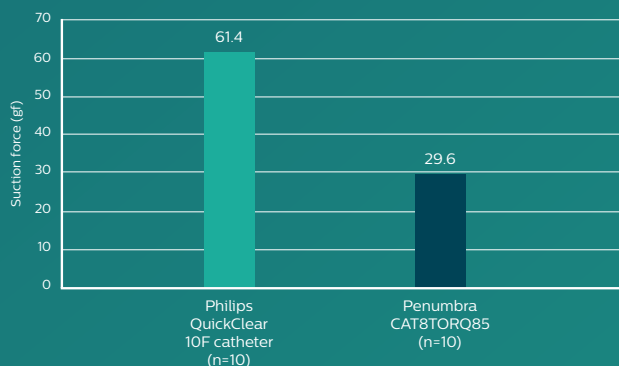

# Simple Optimized performance

QuickClear simplifies the entire thrombectomy procedure workflow. The small footprint of the sterile device allows it to be placed easily and conveniently on the table next to the patient. With the touch-of-a-button, the system is up and running at maximum aspiration power within seconds while the competition takes minutes. The consistency of the aspiration power during the procedure provides physicians more control and supports faster procedure times.

## Directionality

Tip directionality for circumferential aspiration.

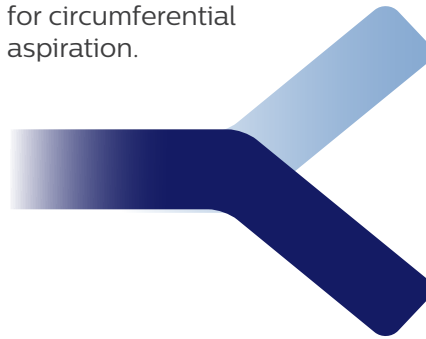

14 mm

# Intuitive Improved user experience

The single, touch-of-a-button design makes controlling aspiration intuitive. Catheters with shaped tip and largest size enable easier thrombus removal in larger vessels.

10F

*QuickClear thrombectomy has greater maximum aspiration pressure than the Penumbra thrombectomy system.\**

QuickClear vs Penumbra aspiration pressure

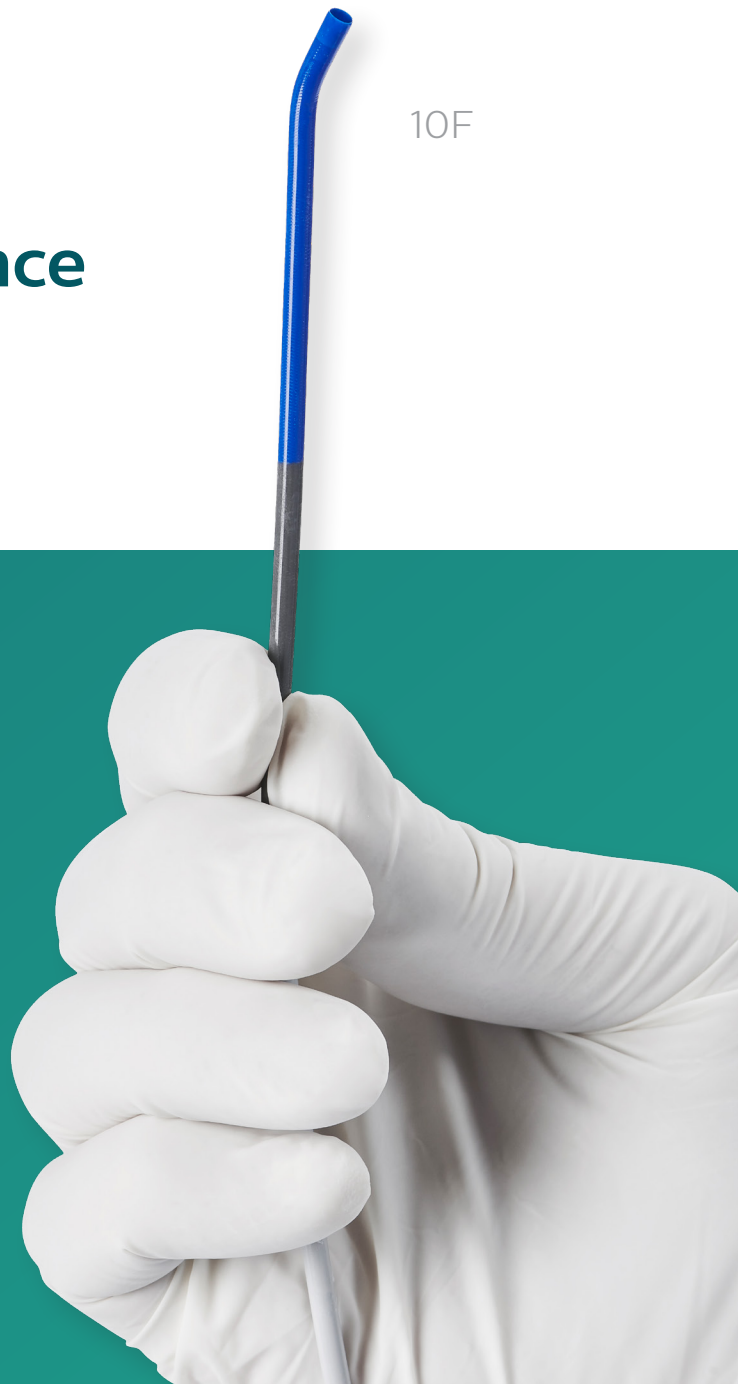
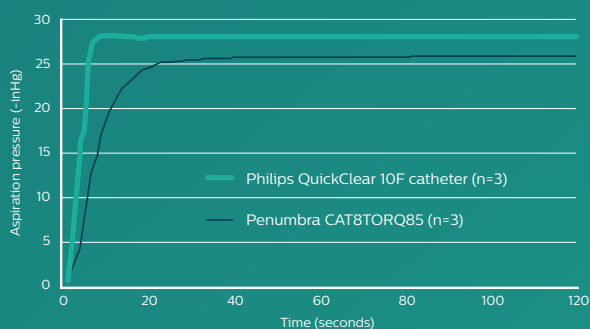

# QuickClear components

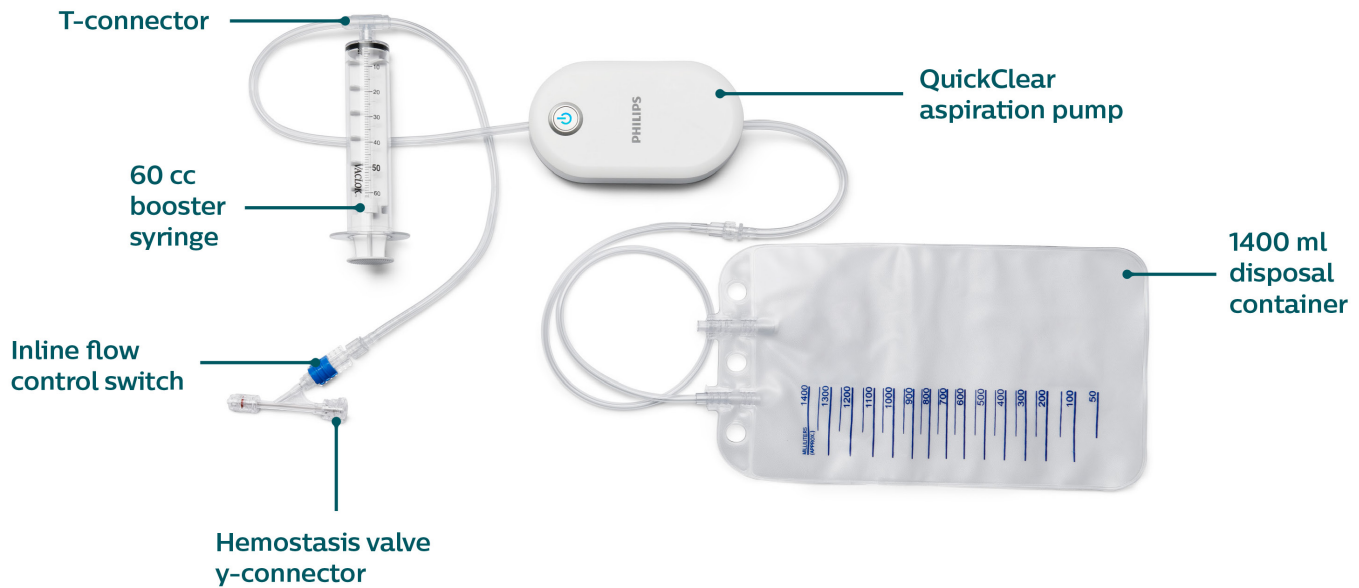

## QuickClear aspiration catheter key specifications

Catalog number	Description	Maximum outer diameter	Lumen inner diameter	Working length	Obturator working length	Tip configuration	Maximum guidewire diameter	Indication
AC6ST130	QuickClear thrombectomy system 6F	.081 inch	.071 inch	130 cm	NA	Straight	0.035 inch	Arterial/ Venous
AC8SH085	QuickClear thrombectomy system 8F	.107 inch	.091 inch	85 cm	102 cm	Shaped	0.035 inch (with obturator)	Arterial/ Venous
AC10SH085	QuickClear thrombectomy system 10F	.130 inch	.111 inch	85 cm	102 cm	Shaped	0.035 inch (with obturator)	Venous

## QuickClear aspiration pump key specifications

<b>Pump dimensions</b>	5.4 in. x 3.0 in x 2.0 in
<b>Tubing length on pump and on waste collection bag (cm)</b>	61, 18, 60
<b>Pump disposal</b>	The aspiration pump contains lithium batteries and is NOT disposable per standard biohazard procedures but should be disposed per standard hospital hazardous waste procedures
<b>Battery voltage</b>	12 VDC nominal
<b>Battery type</b>	The lithium iron-disulfide batteries have similar performance characteristics as lithium ion (high energy capacity, stable voltage, long shelf life, etc.), but they do not have the "spontaneous fire" concerns that many consumer electronics batteries have.
<b>Electrical safety</b>	Meets IEC 60601-1